

outdoor

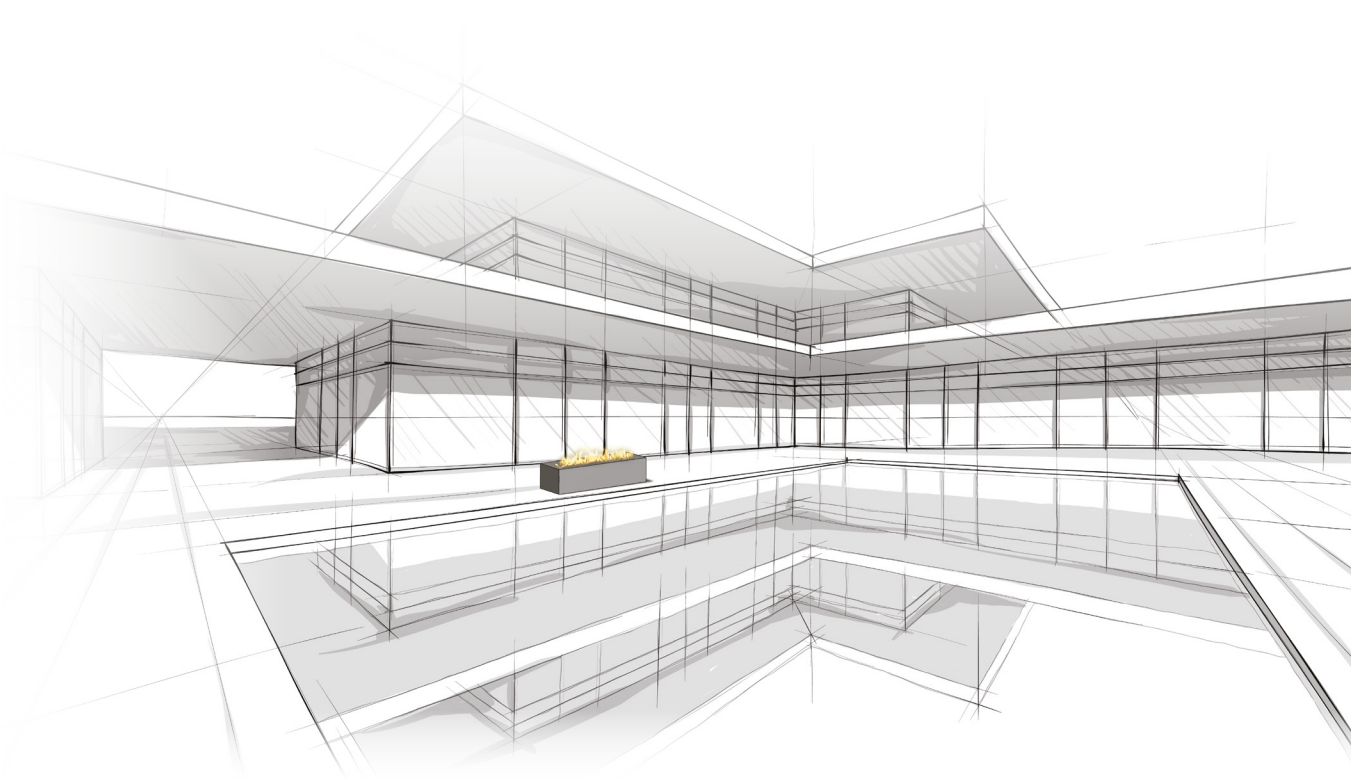

© PLANIKA | Ver. 29072016

www.PLANIKAfires.com

Pyramid Commerce outdoor

Pyramid Commerce

*The bio-fireplace with a decorative twist
Perfect for luxurious commercial areas*

FEATURES:

- Commerce* Technology
- Portable unit
- No smell / no ash / no smoke
- For outdoor / indoor use
- Glass cylinder and lampshade to safely enclose the flames
- Eco-friendly
- TÜV Certified

* Commerce Technology – Advanced technology which prevents fuel leakage due to absorbent ceramic fibres.

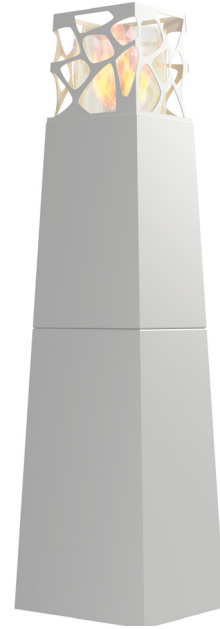

TECHNICAL DATA:

Capacity: 1,5 L / [US] 0,39 gal / [UK] 0,33 gal

Burning time: 3 - 7* h

Heat output: 2,5 kW / 8547 BTU

Net weight: 18 kg / 40 lbs

Finish:

CASING: fibreglass polyester laminate white gloss (RAL 9010), glass tube,

BURNER: stainless steel

* Burning time depends on the amount of fuel poured in



DIMENSIONS:

